

Cherry Hill Estates

NOTE: Please refer to record plat for full description and disclosures regarding Non-Tidal Wetlands, Open Spaces, Forest Retention Areas, Flood Plains, Natural Resource Districts, and Drainage and Utility Easements.

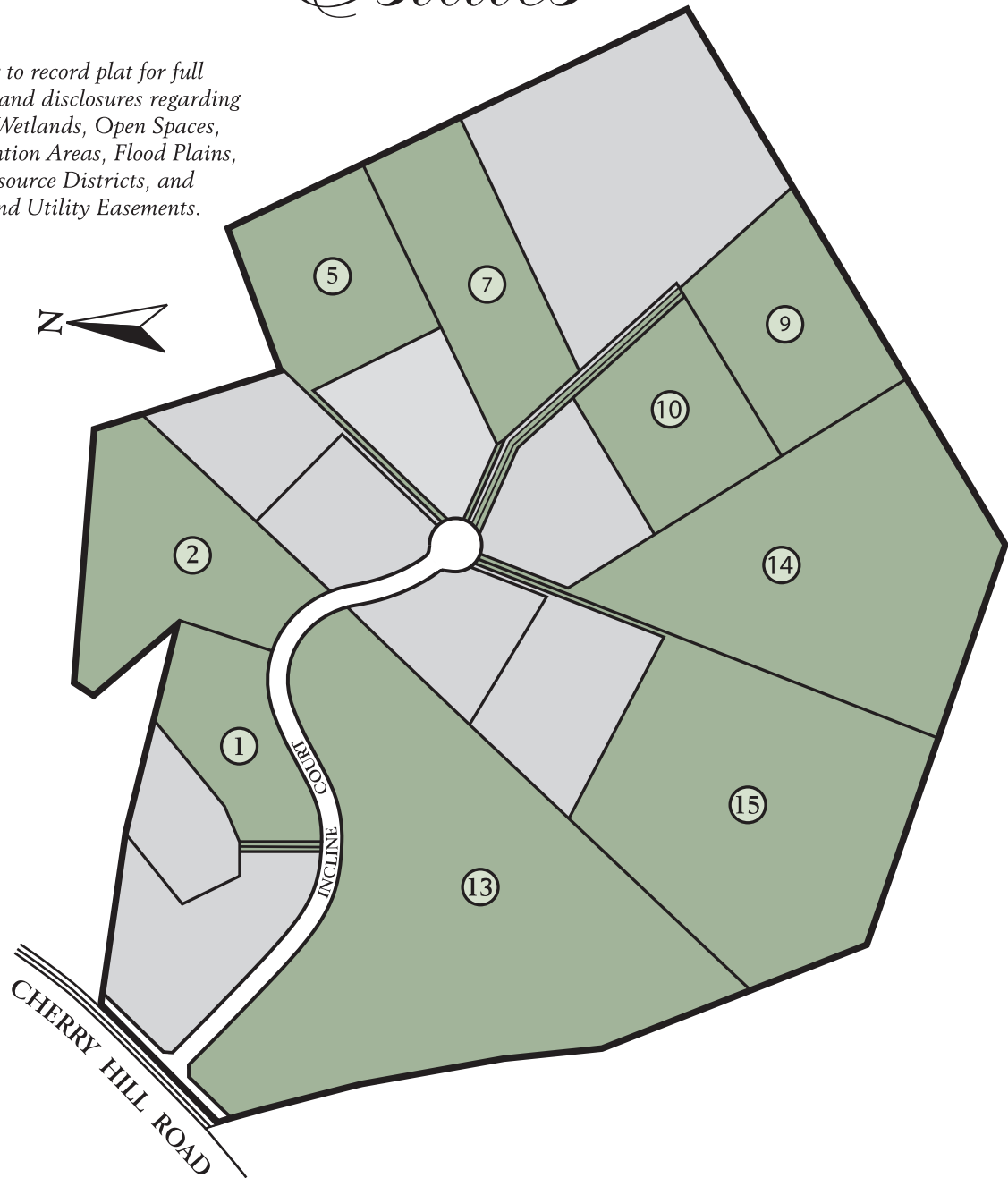

Directions: Maryland route 24 to Bel Air, take 24 Bypass to exit at MD 24 North to Forest Hill/Rocks, follow approx. 3 miles to a right on Cherry Hill Road, follow approx. 1 mile to Incline Court on right.

Gps users: Cherry Hill Road, Street MD. 21050



NOTE: This plan is for illustrative purposes only. Exact location of houses, house types, property lines, parking and landscaping are subject to change without notice. See sales representative for information regarding construction documents and final record plats.

bobward.com

