

Delta Ridge

NOTE: Please refer to record plat for full description and disclosures regarding Non-Tidal Wetlands, Open Spaces, Forest Retention Areas, Flood Plains, Natural Resource Districts, and Drainage and Utility Easements.

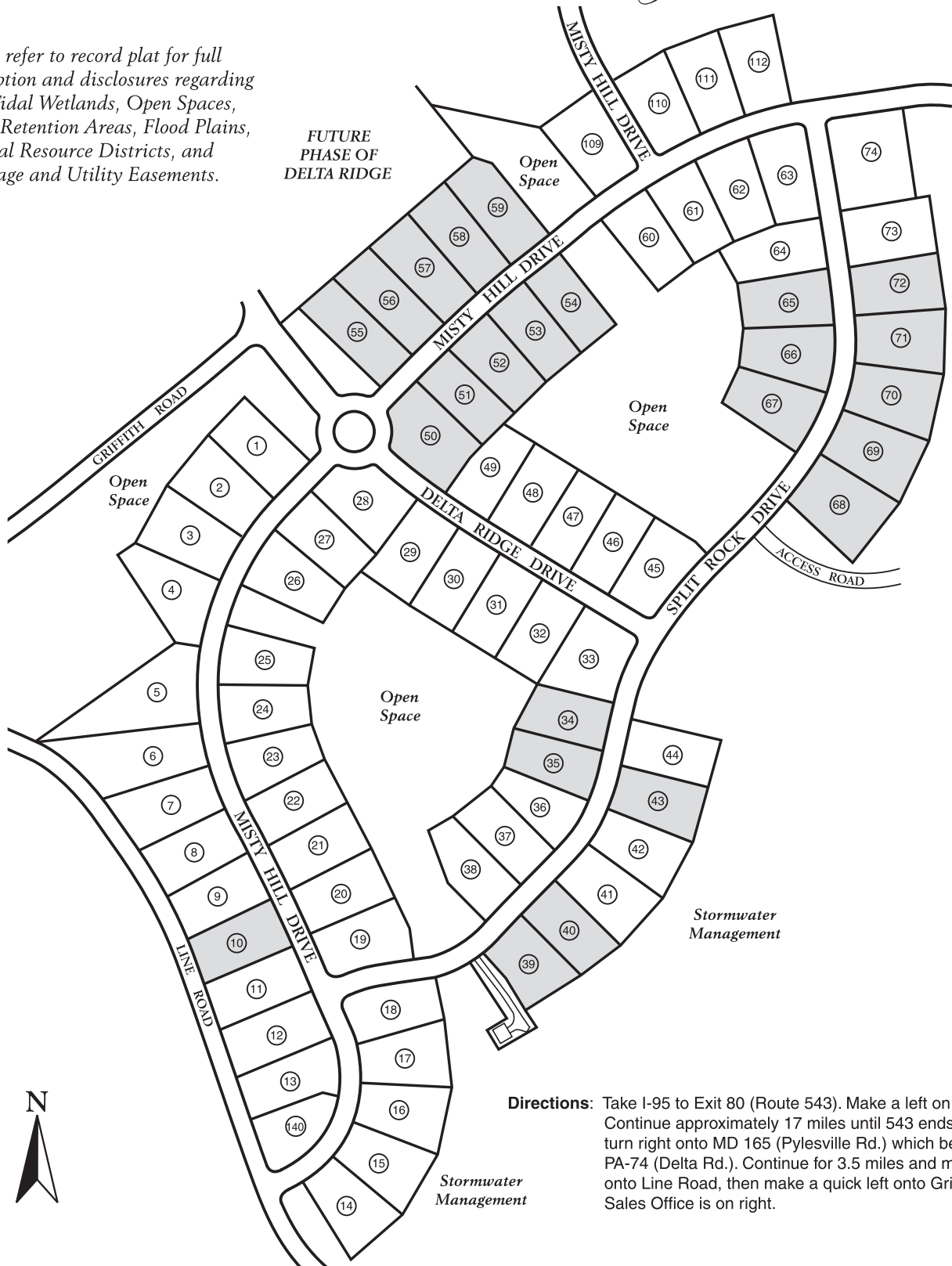

Directions: Take I-95 to Exit 80 (Route 543). Make a left on 543 (north). Continue approximately 17 miles until 543 ends. Then turn right onto MD 165 (Pylesville Rd.) which becomes PA-74 (Delta Rd.). Continue for 3.5 miles and make right onto Line Road, then make a quick left onto Griffith Rd. Sales Office is on right.